

Leaving A Mark

Another way of
experiencing
the city



EASTERN CITY



What does it mean to find ourselves in the city?

Is it to navigate? A means to ground one's self? Or experiencing a place in a different way?

As part of the London Festival of Architecture, 'Leaving a Mark' invites workers and visitors to explore belonging through a self-guided trail connecting sculptural 'City Views' installations across the area, celebrating local stories, architecture, and shared experiences of the City.

About the Eastern City BID

The Eastern City BID brings businesses and people together to create a thriving destination in the tall tower cluster in the City of London.

Wherever you might be, there're plenty of places to see. Feel free to follow our trail in order, or as you make your own journey in the City...

01. Hypha x Eastern City Studios
02. Sky Garden
03. The Monument
04. Lloyd's Building
05. Leadenhall Market
06. St Peter-upon-Cornhill Churchyard

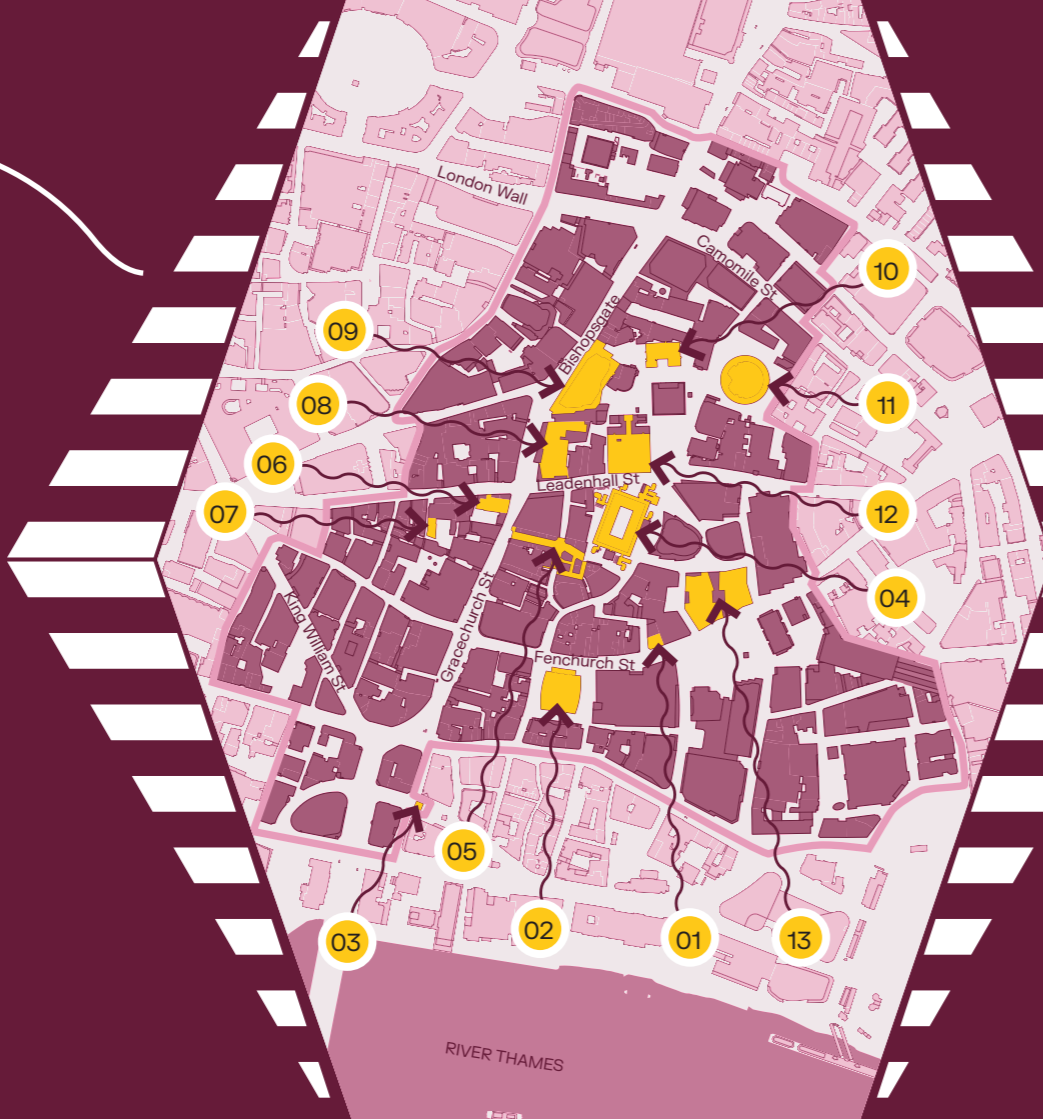

07. Jamaica Wine House
08. The Lookout
09. Horizon 22
10. St Helen's Bishopsgate
11. The Gherkin
12. The Cheesegrater
13. Garden at 120

As part of the London Festival of Architecture, 'Leaving a Mark' invites workers and visitors to explore belonging through a self-guided trail connecting sculptural 'City Views' installations across the area, celebrating local stories, architecture, and shared experiences of the City.

Hypha x Eastern City Studios - 130 Fenchurch Street

Hypha x Eastern City Studios supports independent artists, makers and creative businesses in the heart of the City. The space reflects the growing creative and cultural energy shaping the Eastern City today.



HAVE YOU FOUND US YET?

LOOKING THROUGH THE WINDOW...

'It's a collage of people, culture and ideas...'

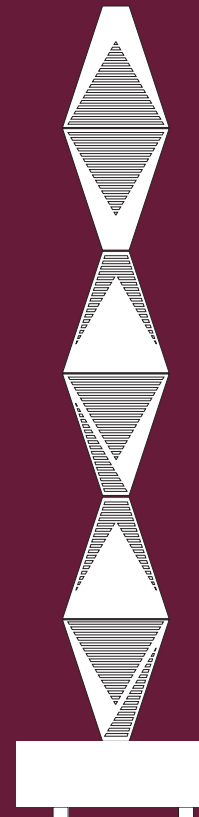

Sky Garden at 20 Fenchurch Street

Located at the top of the famous Walkie Talkie building, Sky Garden brings together indoor gardens, restaurants and some of the best views in London. Since opening in 2015, it has become one of the City's most popular public spaces welcoming over 11 million visitors.



The Monument to the Great Fire of London

Designed by Sir Christopher Wren and Dr Robert Hooke, Monument commemorates the Great Fire of London in 1666. It stands 202 feet tall and is positioned exactly 202 feet from the bakery where the fire is believed to have started.

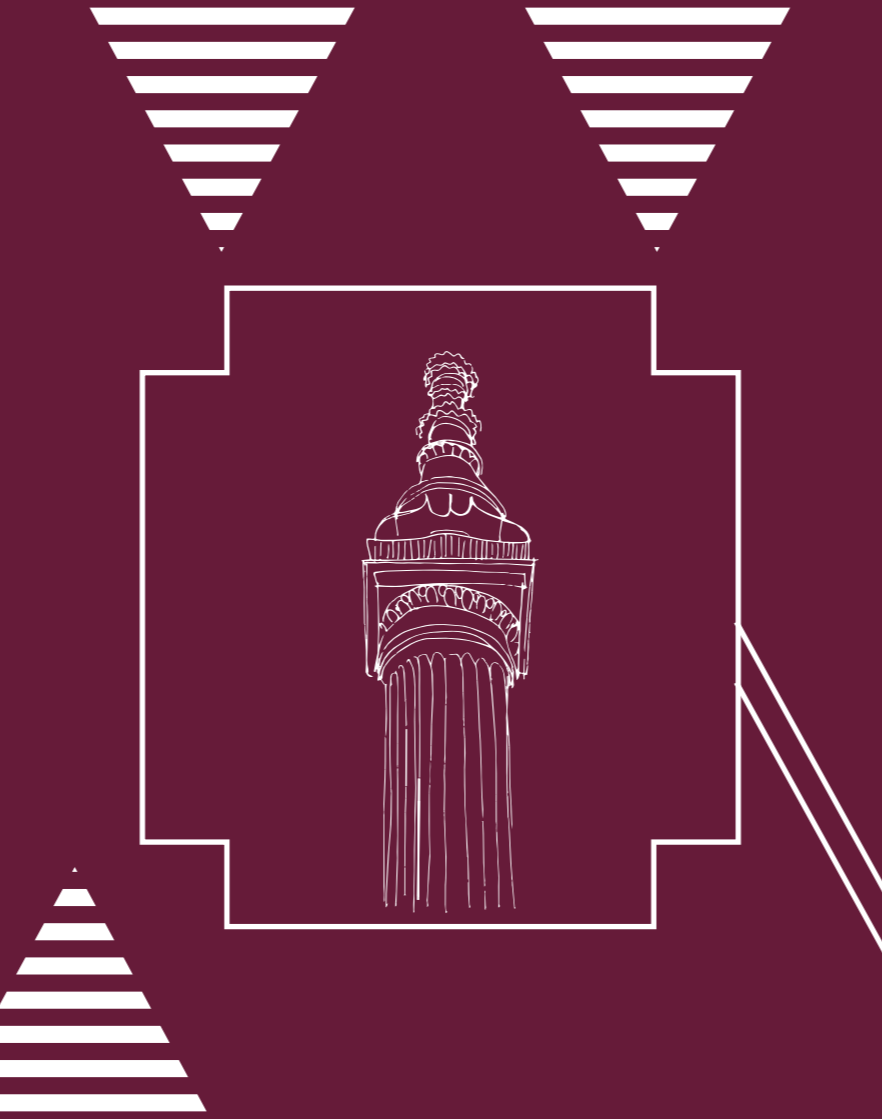

Lloyd's of London Building

Designed by architect Richard Rogers, the Lloyd's Building became famous for turning traditional architecture inside out. Its external lifts and exposed steelwork made it one of the most distinctive buildings in London when it opened in 1986.



Leadenhall Market

Leadenhall Market has been a place of trade and commerce since the 14th century. Today, its Victorian roof, cobbled walkways and colourful storefronts make it one of the City's most loved historic destinations.



If I had something to say about the City...

.....
.....
.....
.....
.....
.....
.....
.....
.....
.....

'You don't need a map... just curiosity...'

St Peter-upon-Cornhill Churchyard

Hidden among the busy streets of the City, St Peter-upon-Cornhill Churchyard offers a quiet green space to pause and relax. The church is believed by some to stand on one of the oldest Christian sites in London.



Jamaica Wine House

Jamaica Wine House stands on the site of London's first coffee house, which opened in 1652. Coffee houses became important meeting places for merchants, traders and business people, helping shape the commercial culture of the City. Today, it remains a popular spot for City workers after work.



The Lookout at 8 Bishopsgate

The Lookout offers free public views from one of the City's newest skyscrapers. Designed with sustainability and public access in mind, it reflects how the Eastern City continues to evolve into a more open and welcoming destination.

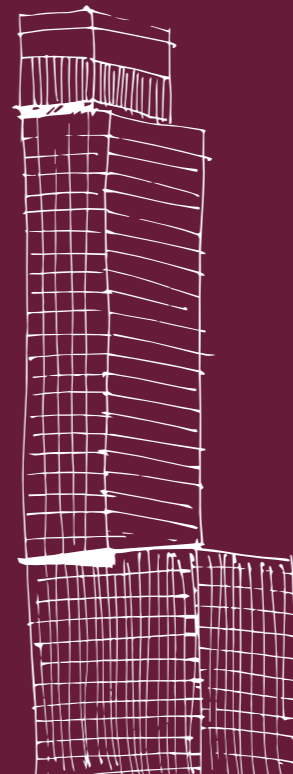
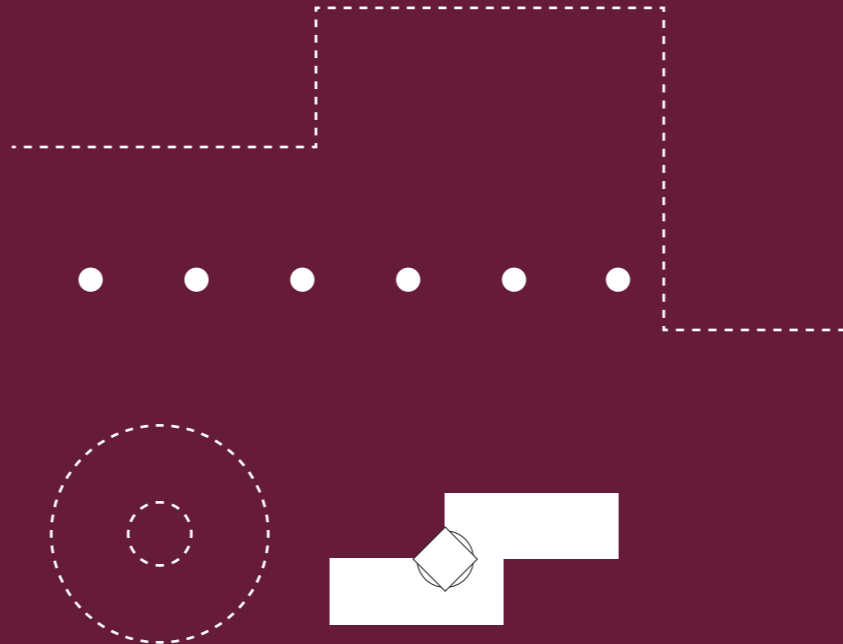

Horizon 22 at 22 Bishopsgate

Home to the highest free public viewing gallery in London and Europe, Horizon 22 offers panoramic views across the capital from the 58th floor. Rising above the City's skyline, the building reflects the Eastern City's position as a global centre for business, innovation and culture.

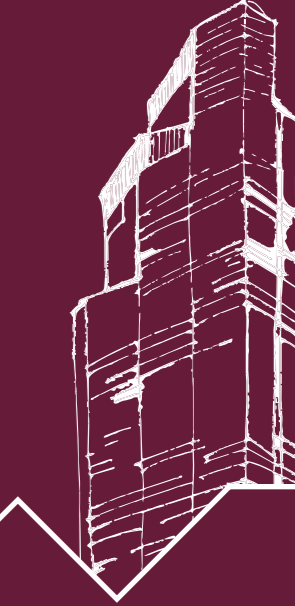
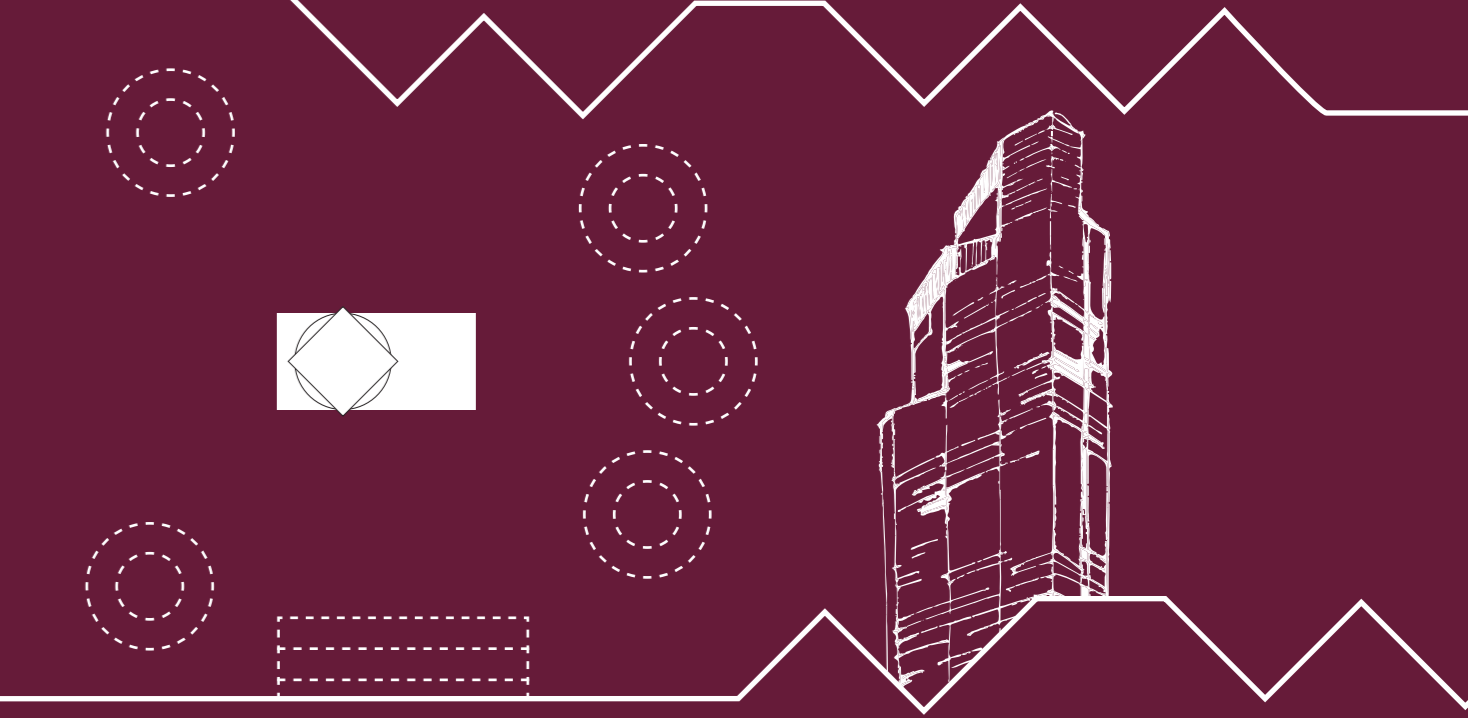
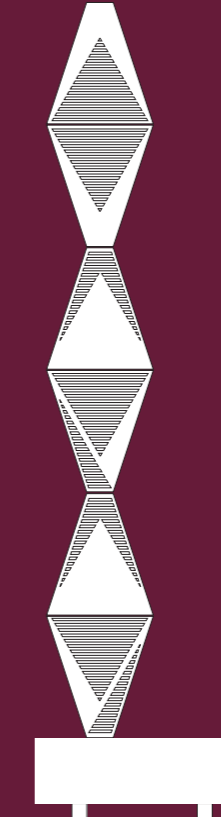

'Getting lost means discovering somewhere better...'

Every alleyway seems to lead to another time. It's all here...'

'It's the place I found my career, my friends'

St Helen's Bishopsgate

Dating back to the 12th century, St Helen's Bishopsgate is one of the few medieval churches in the City to survive both the Great Fire of London and the Blitz during the Second World War. Surrounded today by modern skyscrapers, it remains an important reminder of the City's long history.



30 St Mary Axe 'The Gherkin'

Known around the world for its curved shape, 30 St Mary Axe changed London's skyline when it opened in 2004. Nicknamed "The Gherkin", it quickly became one of the City's most recognisable modern landmarks.

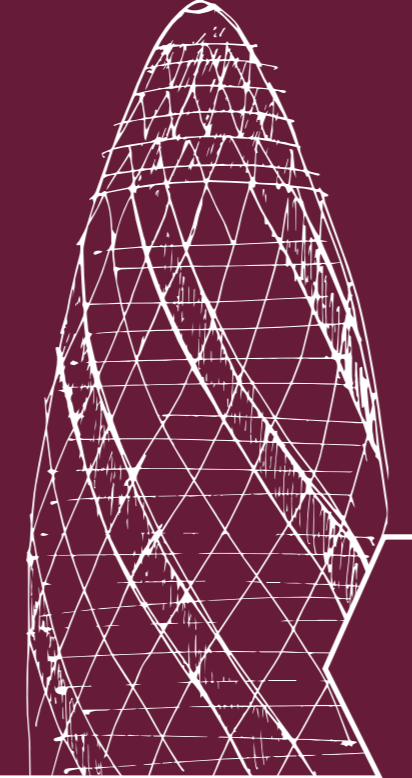

The Leadenhall Building 'The Cheese Grater'

The Leadenhall Building is one of the City's best known skyscrapers. Its sloping design was created to protect views of St Paul's Cathedral, showing how modern architecture and historic London continue to exist side by side.

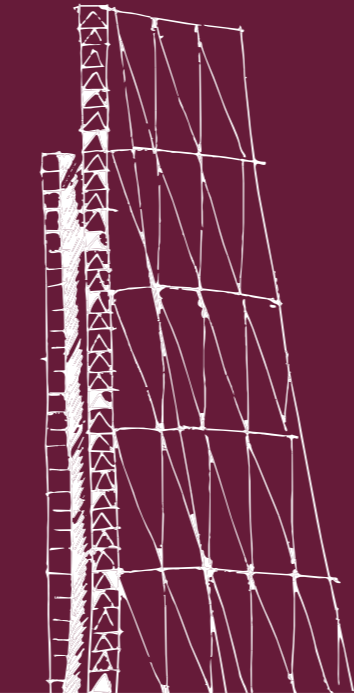

Garden at 120 at 120 Fenchurch Street

Set above Fen Court, Garden at 120 is the City's largest public rooftop garden. Open to everyone free of charge, it combines landscaped gardens, water features and open-air views across the Square Mile.

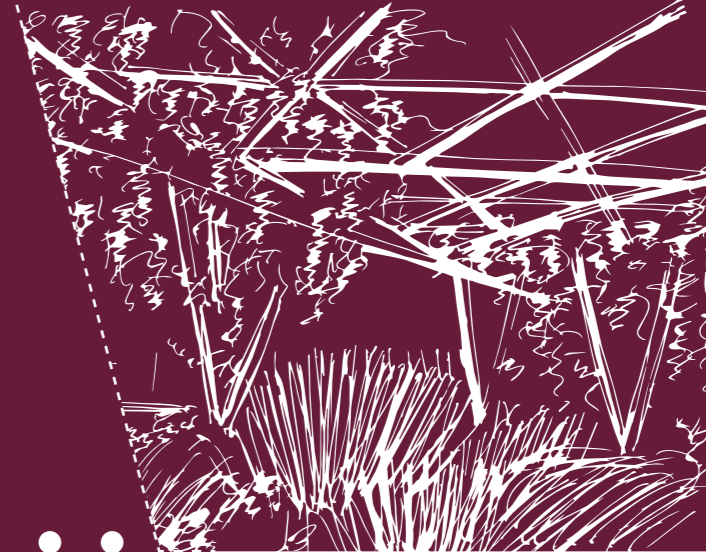
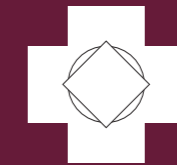
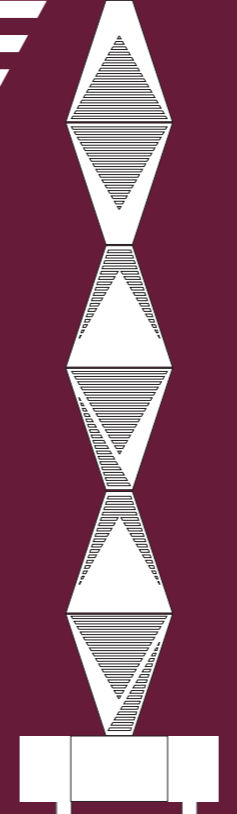

'You take a different alley and find something magical...'

'You hear every language, see every culture, all working together...'

What does your mark look like?

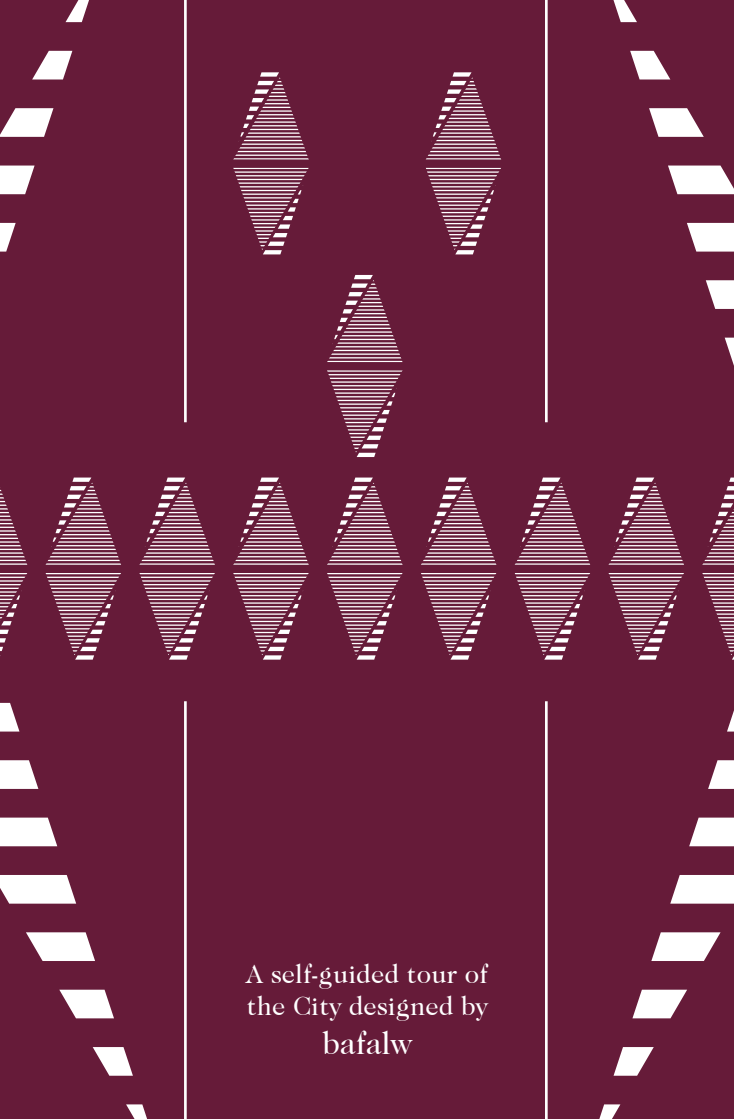

A self-guided tour of
the City designed by
bafalw