

Environment Department

Katie Stewart

Executive Director Environment



Email

Maria.herrera@cityoflondon.gov.uk

Date 15 October 2024

Dear Occupier,

Re: Creechurch Lane area improvements

The City of London Corporation is planning to undertake improvements in the local area to enhance the pedestrian environment and make it more comfortable for people to walk, wheel and cycle. There is also the potential to introduce greenery and tree planting.

The project will include the following:

- A raised crossing at the junction of Creechurch Lane, Bury Street and Mitre Street.
- A permanent street layout to replace the temporary seating and greening measures on Creechurch Lane, to include wider pavements on the eastern side of the street.
- Relocation of payment parking bays, a motorcycle bay and an e-scooter hire bay to provide additional pavement space. Alternative locations have been identified in the vicinity and will be subject to further statutory consultation.
- The introduction of tree planting and greening subject to underground utilities.
- There will be pavement space for businesses to place tables and chairs, however, this is subject to a license and will require further approval.

These proposals are part of a wider initiative that is helping to deliver the objectives of the City of London's Transport and Climate Action Strategies, and to provide an enhanced environment for City visitors, residents and workers. Please refer to the enclosed plans of the project.

Should you have any questions or comments about the proposals please contact the Project Manager, Maria Herrera [maria.herrera@cityoflondon.gov.uk] by the 8th of November 2024.

What happens next:

Feedback from public consultation is reviewed	November 2024
Consultation on traffic management orders commences	November 2024
Site preparation works and removal of temporary street furniture and planters on Creechurch Lane.	early 2025

Construction is planned to commence in spring 2025. Further details on the work programme will be provided in advance.

For further information as to how the City Corporation will process your personal data please see the privacy notice as held at: <https://www.cityoflondon.gov.uk/footer/privacy-notice> or alternatively please contact policy.projects@cityoflondon.gov.uk

Yours faithfully,



Melanie Charalambous,
Portfolio Manager (Transport & Public Realm Projects)
City Operations Division

Creechurch Lane area improvements

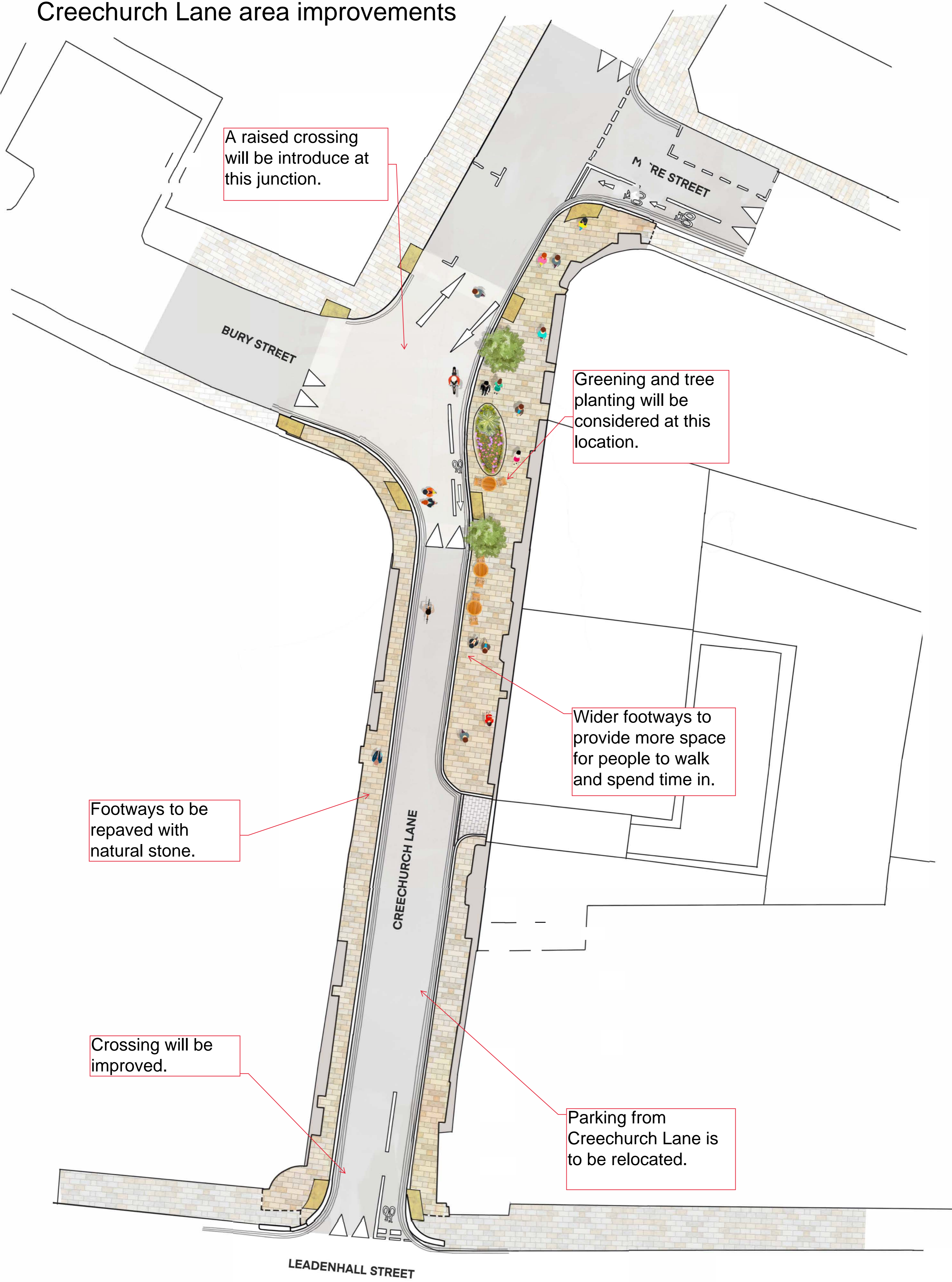

A raised crossing will be introduced at this junction.

Greening and tree planting will be considered at this location.

Wider footways to provide more space for people to walk and spend time in.

Footways to be repaved with natural stone.

Crossing will be improved.

Parking from Creechurch Lane is to be relocated.

LEADENHALL STREET

Proposed location for E-scooter bay

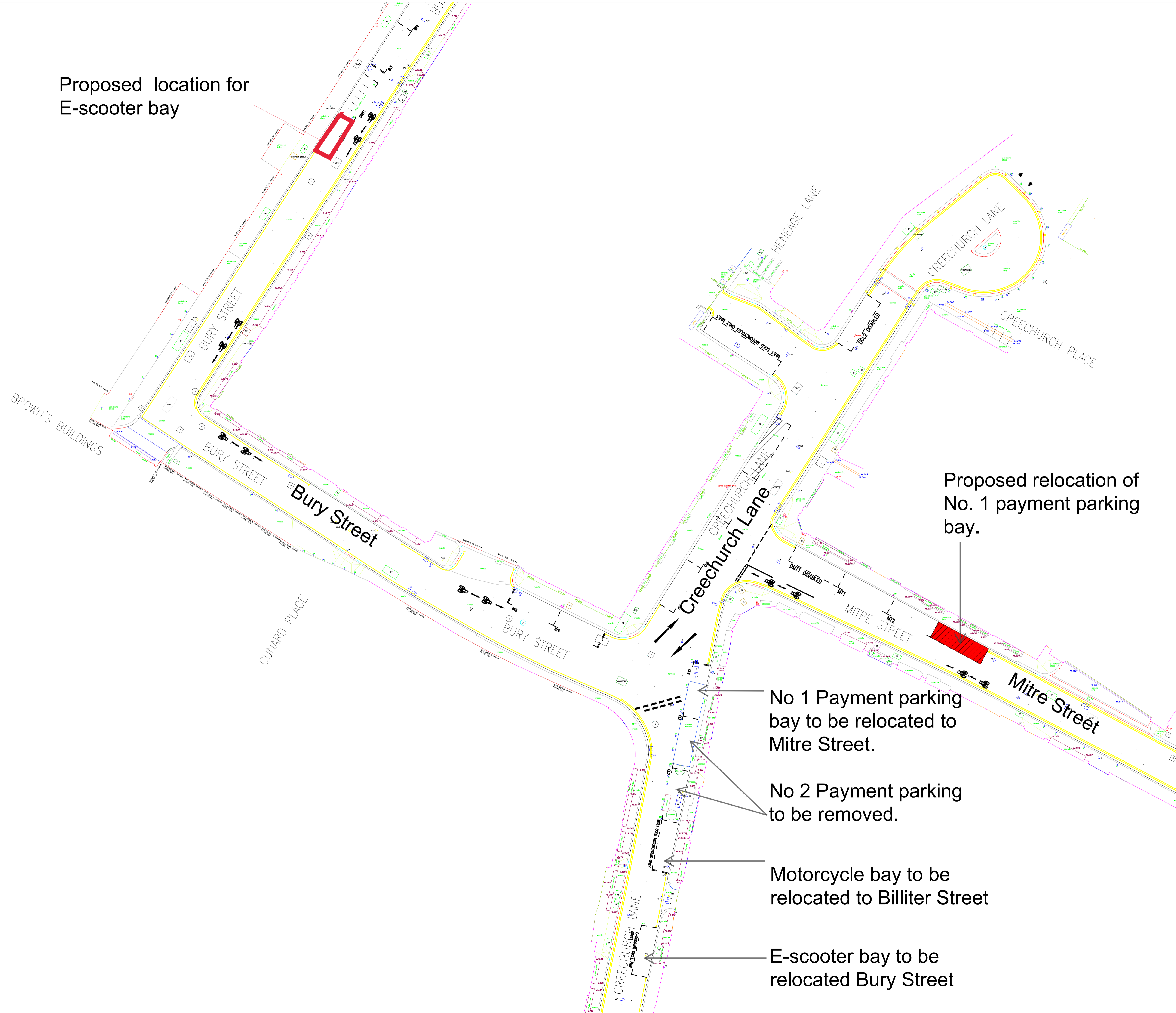

Proposed relocation of No. 1 payment parking bay.

No 1 Payment parking bay to be relocated to Mitre Street.

No 2 Payment parking to be removed.

Motorcycle bay to be relocated to Billiter Street

E-scooter bay to be relocated Bury Street

Rev No.	Date	Description

PROJECT:
CREECHURCH LANE

TITLE:
PARKING BAYS RELOCATION

CLIENT:
HIGHWAY DESIGN AND CONSTRUCTION
ENVIRONMENT DEPARTMENT
PO Box 270
GUILDHALL
LONDON
EC2P 2EJ
TEL: 020 7606 3030



Sheet: SHEET 1 of 1	THIS MAP IS REPRODUCED FROM ORDNANCE SURVEY MATERIAL WITH THE PERMISSION OF ORDNANCE SURVEY ON BEHALF OF THE CONTROLLER OF HER MAJESTY'S STATIONERY OFFICE © CROWN COPYRIGHT 2018. ALL RIGHTS RESERVED. UNAUTHORISED REPRODUCTION INFRINGES CROWN COPYRIGHT AND MAY LEAD TO PROSECUTION OR CIVIL PROCEEDINGS. CITY OF LONDON 100023243 2018.	
Date: 15.04.24		
Designed by: OK		
Checked by: BM		
Scale & Drawing Size: 1:500@A1	Revision: 1	Drawing No: COL/000/1

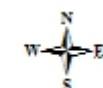

Creechurch Area improvements Billiter Street - motorcycle bay location

 City of London Boundary

Created By:

Date Created
10 Oct 2024

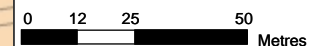

© Crown copyright and database rights 2024 OS AC 0000825908

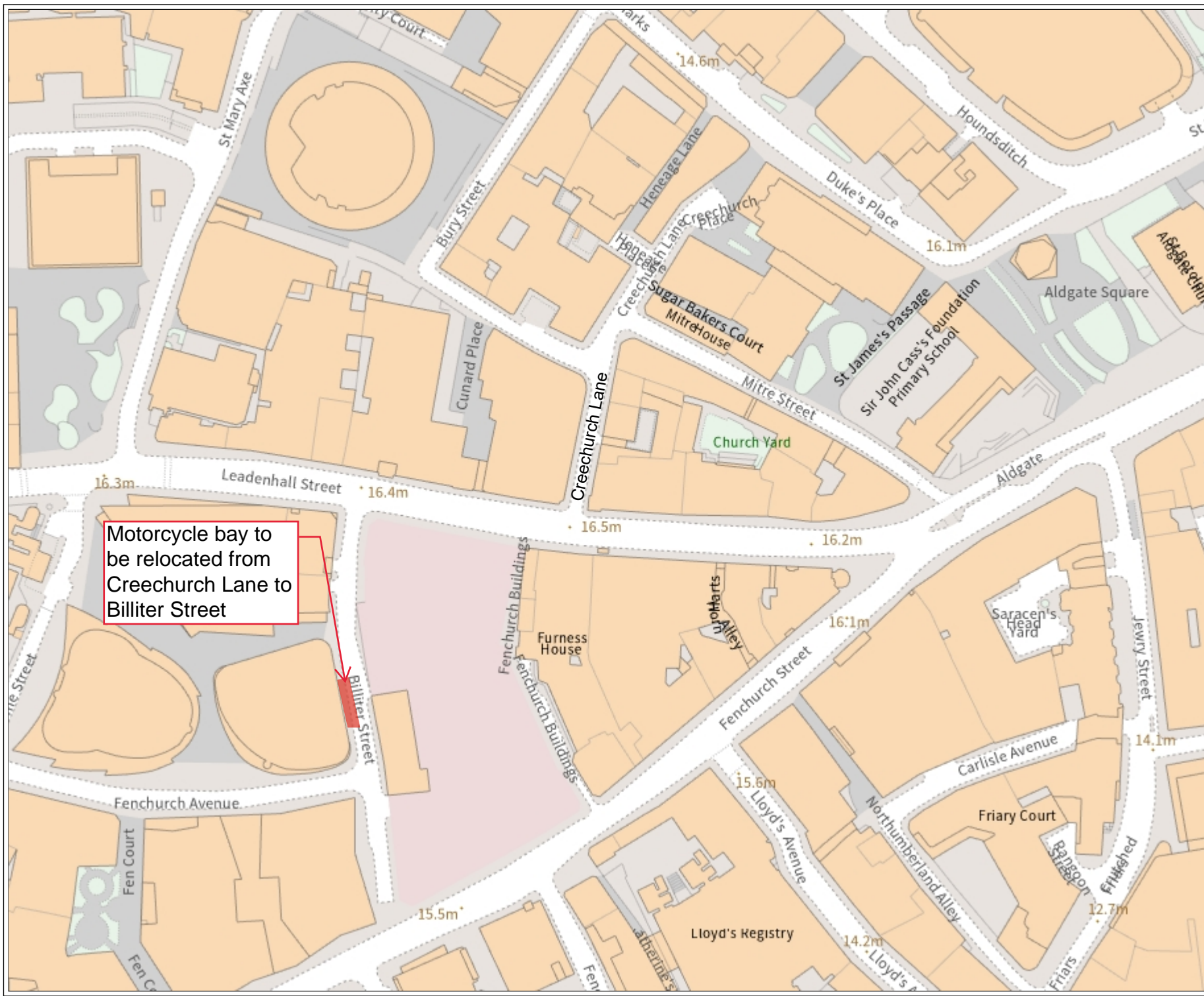

Motorcycle bay to be relocated from Creechurch Lane to Billiter Street